



Everything for the Welder

Wolverhampton
Shrewsbury
Stoke



Official Distributor
Safety and Industrial Products

2024 Edition



Everything for
the Welder

Wolverhampton
Shrewsbury
Stoke



Widely known throughout the UK as a leading stockist and distributor of welding equipment and consumables from leading manufactures, WIRS are also specialists in welding machine repair, servicing, calibration / validation and hire.

Our engineers work to strictly controlled procedures. We carry out validation to BS EN IEC 60974-14 2018 standard and service, inspection to BS EN 60974-4. We work to the ISO 9001:2015 Quality Management System assessed and registered by British Assessment Bureau.

Buy with confidence from our specialist team at WIRS. Our extensive stock (of over 3,500 product lines) is housed in our own warehouse.

This means we supply direct to our customers without having to rely on 3rd party companies and can take full responsibility to deliver our services, on time and at the right price.

At WIRS our team put the customer first. Our success is built on the ongoing rapport we have with welding specialists throughout the Midlands, Wales and the North.

We maintain this by ensuring a fast, reliable, cost effective all round service, supplying a full range of welding supplies and equipment including machines, PPE clothing and consumables. We also specialise in Mig/Mag fume extraction welding torches both supply and repair, using bespoke industry leading equipment and knowledge.



www.wirs.co.uk | sales@wirs.co.uk | 01902 712525

Contents

3M™ Speedglas™

3M™ Speedglas™ Heavy Duty Welding Helmet G5-01	4
3M™ Speedglas™ Heavy Duty Welding Helmet G5-03	5
3M™ Speedglas™ Heavy Duty Welding Helmet G5-01 & G5-03 - Spares & Accessories	6
3M™ Speedglas™ Welding Helmet G5-02	8
Spares & Accessories	9
3M™ Adflo™ Powered Air Respirator	10
3M™ Adflo™ Powered Air Respirator System	11
3M™ Speedglas™ Welding Helmet 9100 MP & 9100 MP-LITE	13
Spares & Accessories	14

3M™ Versaflo™ Helmets

3M™ Versaflo™ M-Series Helmets	16
--------------------------------------	----

3M™ Versaflo Kits & 3M™ G500 Headgear

3M™ Versaflo™ Powered Air Turbo Heavy Industry Ready Kit TR-300E+ HIK	17
3M™ Versaflo™ Powered Air Turbo Starter Kit	17
3M™ G500 Headgear	17

3M™ Respiratory

Disposable Respirators	18
3M™ Maintenance Free Reusable Half Mask 4000+ Series	19
3M™ Secure Click™ Half Mask Reusable Respirator, Speaking Diaphragm, HF-800SD series	19

3M™ Hearing Protection

3M™ Earplugs 1100 Series	20
3M™ E-A-R™ Classic™ Earplugs	20
3M™ E-A-R™ E-A-Rsoft™ Yellow Neons™ Earplugs	20
3M™ PELTOR™ X Series	21

3M™ Eye Protection

Safety Glasses	22
Safety Goggles	23

3M™ Fibre Discs & Flap Discs	24
------------------------------------	----

3M™ Cut-Off Wheels & Grinding Wheels	25
--	----

Surface Conditioning Discs and Bristle Discs	26
--	----

3M™ Speedglas™

3M™ Speedglas™ Heavy Duty Welding Helmet G5-01



The 3M™ Speedglas™ Welding Helmet G5-01 fits both your 3M™ Adflo™ Powered air Respirator as well as the 3M™ Versaflo™ Supplied Air Regulators.

Based on extensive input from welders working on heavy-duty, high-amperage welding and grinding, it's auto-darkening helmet is designed to be as versatile as you are.

3M™ Speedglas™ Welding Filter G5-01TW

Part No.	Description
61 78 20	Complete powered air system Helmet G5-01 with welding filter G5-01TW and Adflo high altitude respirator
61 78 29	Complete powered air system + consumable starter kit Helmet G5-01 with welding filter G5-01TW, consumable kit (79 20 00) and Adflo high altitude respirator
61 11 20	Upgrade your old powered air system Helmet G5-01 with welding filter G5-01TW

3M™ Speedglas™ Welding Filter G5-01VC

Part No.	Description
61 78 30	Complete powered air system Helmet G5-01 with welding filter G5-01VC and Adflo high altitude respirator
61 78 39	Complete powered air system + consumable starter kit Helmet G5-01 with welding filter G5-01VC, consumable kit (79 20 00) and Adflo high altitude respirator
61 11 30	Upgrade your old powered air system Helmet G5-01 with welding filter G5-01VC



3M™ Speedglas™ Welding Helmet G5-03 Pro

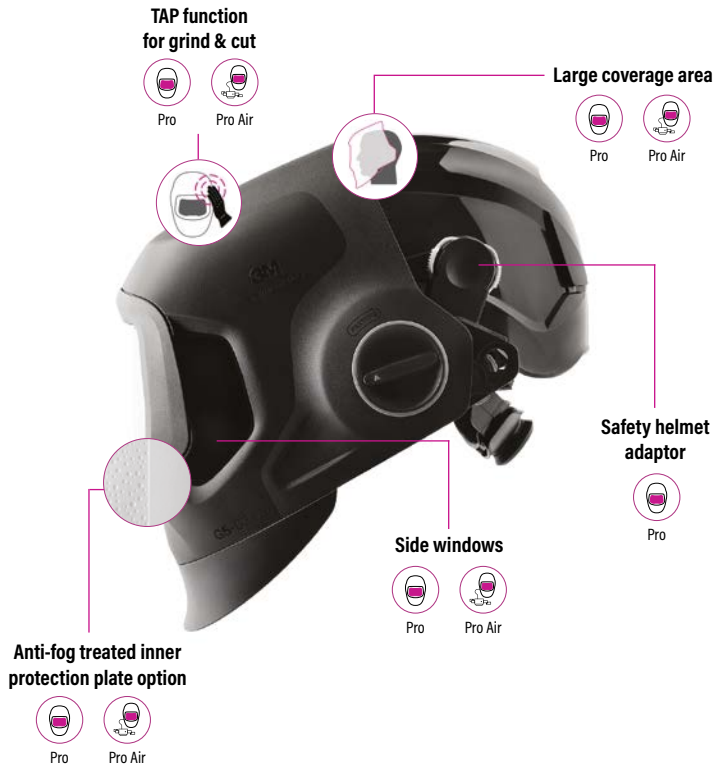

Multiple welding filter choices



Common parts with G5-01 Accessories, welding filters, protection plates

3M™ Speedglas™ Welding Helmet G5-03 Pro Air







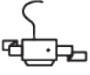

3M Part No.	Material Description
63 77 20	3M™ Speedglas™ Welding Helmet G5-03 Pro Air TW Adflo
63 77 30	3M™ Speedglas™ Welding Helmet G5-03 Pro Air VC Adflo
63 18 20	3M™ Speedglas™ Welding Helmet G5-03 Pro TW
63 18 30	3M™ Speedglas™ Welding Helmet G5-03 Pro VC

Safety helmet sold separately.

3M™ Speedglas™ Welding Helmet G5-03

This welding helmet is designed for the welder who may need...

 ...filtered air	 ...an excellent view	 ...protection against arc welding radiation
 ...to perform grinding tasks	 ...a comfortable and well-balanced helmet	 ...safety helmet compatibility

The helmet features an option of three different auto darkening and four shades of passive welding filter.



Designed for the professional welder, 3M Speedglas™ G5-03 Series welding helmets offer modularity and multiple choice of accessories.

3M™ Speedglas™ Heavy Duty Welding Helmet G5-01 & G5-03 - Spares & Accessories

To optimise the effective lifetime of your welding equipment and avoid the additional cost of replacement, regular maintenance is important. Replace all damaged parts immediately to ensure correct levels of protection. Below is a helpful overview; always read and follow user instructions.

Before use

- **Helmet and head harness.** Inspect for cracks or any damaged parts. Replace if needed.
- **Cover lenses and visor.** To provide the best possible vision, they should be clean and without scratches.
- **Face seal.** If the face seal is damaged there is a great risk that contaminated air will get inside the helmet. Verify it's in position and free from splits and tears.
- **Welding filter.** Ensure that the low battery indicator is not flashing and check that the sensors are clean and uncovered.
- **Breathing tube.** Confirm that the tube is not damaged or leaking any air. To extend the life of the breathing tube, use a tube cover or a heavy-duty breathing tube.

After use

- **Clean the helmet.** Wipe with a moist tissue or cloth, both inside and outside the helmet. If you suspect that the inside of the breathing tube is dirty, it must be changed. DO NOT rinse, immerse in water or clean with solvents.
- **Face seal and sweatband.** Remove for additional cleaning as needed and replace if they have splits or tears or whenever they become unhygienic.
- **Cover lenses and visor.** Clean with a soft cloth and replace if any pits or scratches occur.
- **Breathing tube.** Replace if damaged, deformed or leaking any air.
- **Storage.** Store the helmet in a dry, clean area away from direct sunlight, high temperatures and solvents.

Spare parts and consumables

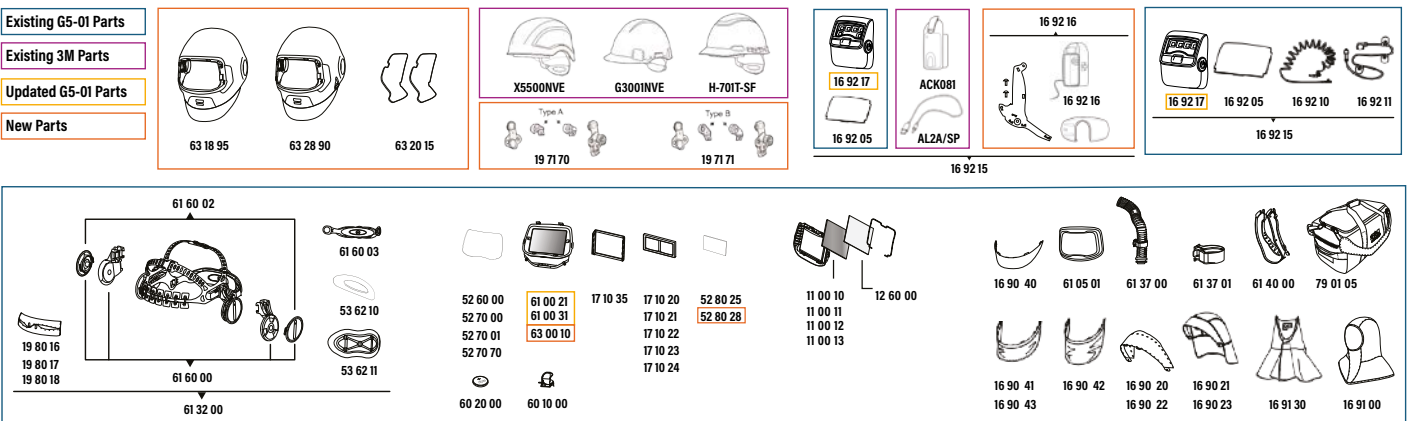

Part No.	Description	Part No.	Description	Part No.	Description
11 00 10	Passive Lens 90 110 shade 10	17 10 20	Magnifying Lens 1.0X	61 00 21	Welding Filter G5-01/03TW
11 00 11	Passive Lens 90 110 shade 11	17 10 21	Magnifying Lens 1.5X	61 00 31	Welding Filter G5-01/03VC
11 00 12	Passive Lens 90 110 shade 12	17 10 22	Magnifying Lens 2.0X	61 05 01	Helmet Front Cover Flip Up, G5-01
11 00 13	Passive Lens 90 110 shade 13	17 10 23	Magnifying Lens 2.5X	61 32 00	Head Harness G5-01
12 60 00	Speedglas™ Outer Protection Plate, 10V	17 10 24	Magnifying Lens 3.0X	61 37 00	Air duct Breathing Tube (Short) Inc Holder
16 90 20	Head Protection Fabric (Small)	17 10 35	Magnifying Lens Holder	61 37 01	Breathing Tube Holder
16 90 21	Head Protection Fluorescent Yellow	19 71 70	Hard Hat Adaptor G5-03 (X5)	61 40 00	Face Seal G5-01
16 90 22	Head Protection Leather	19 71 71	Hard Hat Adaptor G5-03 Pro (H7/G3)	61 60 00	Pivot & Sliding Mechanism Inc Pivot Knobs
16 90 23	Head Protection Fabric (Large)	19 80 16	Sweatband, Towelling	61 60 02	Pivot Knobs
16 90 40	Neck Protection Rigid	19 80 17	Sweatband, Fleecy Cotton	61 60 03	Head Harness Back Part G5-01
16 90 41	Neck Protection Fabric (Small)	19 80 18	Sweatband, Leather	63 00 10	Welding Filter
16 90 42	Neck Protection Fabric (Large)	52 60 00	Lens Cover Outer Standard Pk=10	63 18 95	Welding helmet replacement shell
16 90 43	Neck Protection Leather	52 70 00	Lens Cover Outer Hard Coated Pk=10	63 20 15	Welding helmet side window cover plate G5-03 Pro
16 91 00	Head Cape Tecaweld	52 70 01	Outer Protection Plate, Scratch Resistant	63 28 90	Welding helmet Replacement shell with air duct G5-03 Pro
16 91 30	Shroud	52 70 70	Lens Cover Outer High Heat Pk=10	79 01 05	Carry Bag Speedglas Heavy Duty
16 92 05	Lens Cover Task Light Pk=5	52 80 25	Lens Cover Inner Pk=5	ACK081	Rechargeable Li-ion Battery Pack, 3.7V, 1800mAh
16 92 10	Long Power Cable for Task Light	52 80 28	Inner Cover Plate Antifog G5-01/03	AL2A/SP	Battery Charging Cable for ACK081 Battery, USB, AL2A/SP
16 92 11	Short Power Cable for Task Light	53 62 10	Head Harness Back Cushion G5-01 (Small)	G3001NVE	Safety Helmet
16 92 15	TL Kit Head mounted battery G5-01/03	53 62 11	Head Harness Back Cushion G5-01 (Large)	H-701T-SF	Safety Helmet
16 92 16	TL holder for battery G5-01/03	60 10 00	Battery Holder	X5500NVE	Safety Helmet
16 92 17	Helmet replacement Task Light for G5-01/03	60 20 00	Filter Battery, CR2450		

3M™ Speedglas™ Heavy Duty Welding Helmet **G5-01 & G5-03** - Spares & Accessories

These accessories are offered so that the G5-01 & G5-03 can be configured to meet individual preferences and application needs.



BPK-HD



83 50 20



16 90 30



16 91 00



16 20 21



16 90 23



83 71 10



83 71 20



83 72 42
83 75 42



16 92 00



16 90 20



16 90 22



16 90 41



16 90 42



16 90 43

Part No.	Description
BPK-HD	Heavy duty backpack
16 90 21	Head protection - fluorescent yellow
16 90 22	Head protection - leather
16 90 23	Head protection - fabric (large)
16 90 24	Scrape guard (not shown)
16 90 30	Shroud
16 90 35	Extended cover kit (shroud and large head cover - fabric)
16 90 41	Neck protection in fabric (small)
16 90 42	Neck protection in fabric (large)

Part No.	Description
16 90 43	Neck protection - leather
16 92 00	Task light, incl. mounting parts and cables
16 92 05	Protection plate for task light, pkg. of 5
16 92 10	Long power cable for task light
16 92 11	Short power cable for task light
16 92 23	Pouch with Adflo battery, for task light when using supplied air regulator (not shown)

Part No.	Description
83 40 18	Flame resistant breathing tube cover (recommended when using the task light)
83 50 20	Braces for respirator
83 71 10	Adflo odour filter
83 71 20	Odour filter pad
83 72 42	Adflo gas filter A1B1E1
83 75 42	Adflo gas filter A2

3M™ Speedglas™ Welding Helmet G5-02

The world's first curved auto-darkening filter with the 3M™ Speedglas™ Welding Helmet G5-02.

Featuring Curved Glass Technology, the welding filter follows the curved shape of your head and is more in line with the range of your peripheral vision.

- Designed for high-end TIG welders
- Curved welding filter technology tested and approved by professional TIG welders
- New world standard for precision welding filter viewing
- Slim style helmet created to optimise view and comfort
- Filter reliably switches even at very low (eg. 1amp) TIG settings, meeting the new pr ISO 16321 'TIG+' standards
- New exhaled air venting design reduces heat and humidity for added comfort
- Four arc sensors
- Natural colour technology
- Magnifying lens options
- 3M™ Connected Equipment App available for logging maintenance, statistics, activation etc.



Part No.	Description
62 11 20	3M™ Speedglas™ Welding Helmet G5-02 with Curved Welding Filter, Headband, Cleaning Wipe & Bag



3M™ Speedglas™ Welding Helmet G5-02 - Spares & Accessories

To optimise the effective lifetime of your welding equipment and avoid the additional cost of full replacement, regular maintenance is important. Replace all damaged parts immediately to ensure correct levels of protection, see parts list below of spare parts and accessories for this specific helmet. Here are some maintenance tips to keep you going; always read and follow all User Instructions.

Before use

- **Helmet and headband.** Inspect for cracks or any damaged or defective parts. Replace if needed.
- **Welding filter.** Ensure that your welding filter is equipped with an outer and inner protection plate and check that the sensors are clean. Replace the battery if the low battery indicator flashes or if the indicators do not flash when the buttons are pressed.
- **Protection plates.** To provide the best possible vision they should be clean and without scratches. Use a moist tissue or cloth, like the cleaning wipe that comes with the helmet.
- **Magnification.** If needed try one of our magnifying lenses, available in x1.5, x2.0, x2.5 strengths. The lens is to be attached to the inner protection plate and can be adjusted up/down depending on your work position.

After use

- **Clean the helmet.** Wipe with a moist tissue or cloth, both inside and outside the helmet. DO NOT rinse, immerse in water or clean with solvents.
- **Sweatband.** Remove for additional cleaning as needed and replace whenever it become worn or unhygienic.
- **Welding filter.** Clean the welding filter and protection plates with a lint-free tissue or cloth. As the protection plates becomes deeply pitted, scratched or too dirty to clean with soft cloth, it's time to replace them.
- **Storage.** Store the helmet in a dry, clean area away from direct sunlight, high temperatures and solvents. Ideally use the bag that comes with the helmet.



Spare parts and consumables

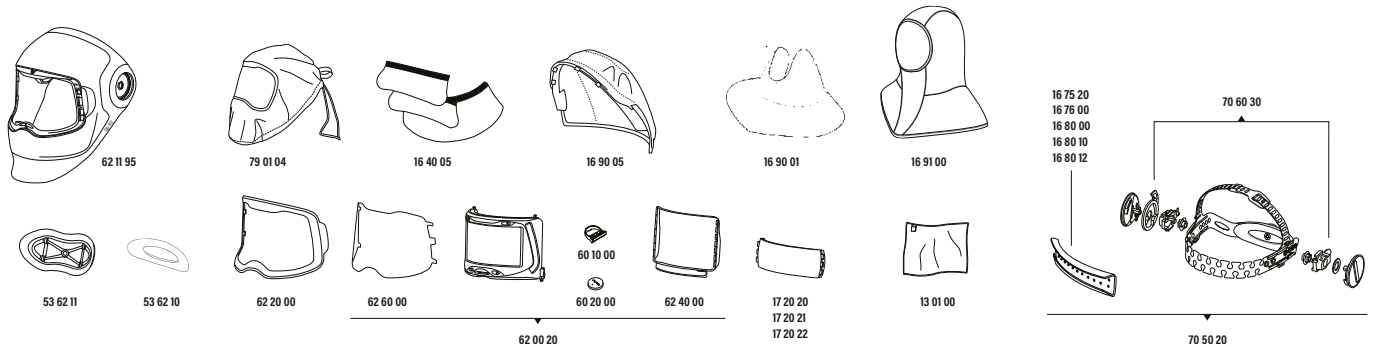

Part No.	Description	Part No.	Description	Part No.	Description
13 01 00	3M cleaning wipe	16 91 00	Hood black/grey	62 11 20	Helmet G5-02 with welding filter, headband, cleaning wipe and bag.
16 40 05	Ear and neck protection in leather (3 parts)	17 20 20	Magnifying lens x1.5	62 11 95	Helmet without welding filter, without headband, without front cover.
16 90 05	Head protection in fabric	17 20 21	Magnifying lens x2.0	62 20 00	Front cover.
16 75 20	Sweatband, towelling, purple, pkg of 2	17 20 22	Magnifying lens x2.5	62 40 00	Inner protection plates, pkg of 2.
16 76 00	Sweatband, towelling, pkg of 20	53 62 10	Cushion part for headband	62 60 00	Scratch resistant outer protection plate, pkg of 5.
16 80 00	Sweatband, leather	53 62 11	Large head rest	70 50 20	Headband with assembly parts and sweatband.
16 80 10	Sweatband in fleecy cotton (length 24 cm), pkg of 2	60 10 00	Battery holder	70 60 30	Assembly parts (pivots) for headband.
16 80 12	Sweatband in fleecy cotton (length 21 cm), pkg of 2	60 20 00	Battery CR2450 Lithium 3V	79 01 04	Helmet storage bag.
16 90 01	Neck protection	62 00 20	Curved welding filter G5-02, incl inner and outer protection plates		

3M™ Adflo™ Powered Air Respirator



To optimise the effective lifetime of your welding equipment and avoid the additional cost of replacement, regular maintenance is important. Replace all damaged parts immediately to ensure correct levels of protection.

Before use

- **Battery.** Ensure that it's adequately charged and fitted correctly.
- **Motor body.** Inspect the unit for damage and ensure it's firmly fixed to the belt. Ensure filters are correctly fitted.
- **Breathing tube.** Inspect the tube and connections to ensure they are free from splits and holes. Replace if damaged, deformed or leaking any air. To extend the life of the breathing tube, use a tube cover or the heavy-duty rubber breathing tube.
- **Air flow check.** Fit the breathing tube to the unit and attach the airflow meter in the other end of the tube and switch on the Adflo PAPR. If the ball does not rise above the line, continue fault finding.
- **Alarm check.** Cover the air outlet of the airflow meter with your hand until an audible warning is heard and the red indicator illuminates. Remove your hand. The alarm should now stop.

After use

- **Clean the equipment.** Wipe the motor body with a moist tissue or cloth. If you suspect that the inside of the breathing tube is dirty, it must be changed. DO NOT rinse, immerse in water or clean with solvents. DO NOT attempt to remove contamination of filters as this will damage the filters and void the warranty.
- **Replace damaged parts.** Replace all damaged parts to guarantee the proper functioning of the respirator. Worn out components should be disposed of according to local regulations.
- **Spark arrestor.** Replace if deformed and no longer fitting well.
- **Pre-filter.** Replace regularly to extend the life of the particle filter. This will save money and also extend the battery run-time.
- **Particle filter.** Check the filter indicator position and replace if the red LED is lit. Otherwise, replace whenever the battery operating time becomes too short, or when "fully loaded" filter triggers low airflow alarm.
- **Gas filter.** Replace the gas filter according to your work place requirements. Do not wait until you can smell odours.
- **Odour filter.** Replace any time you smell unpleasant odours. Odour filter is not required if gas filter is used.
- **Storage.** Put the battery/turbo unit on charge after use. When stored, recharge every six months. Store the unit in a dry, clean area away from direct sunlight, high temperatures and solvents. For example use the Adflo storage bag.

Spare parts and consumables

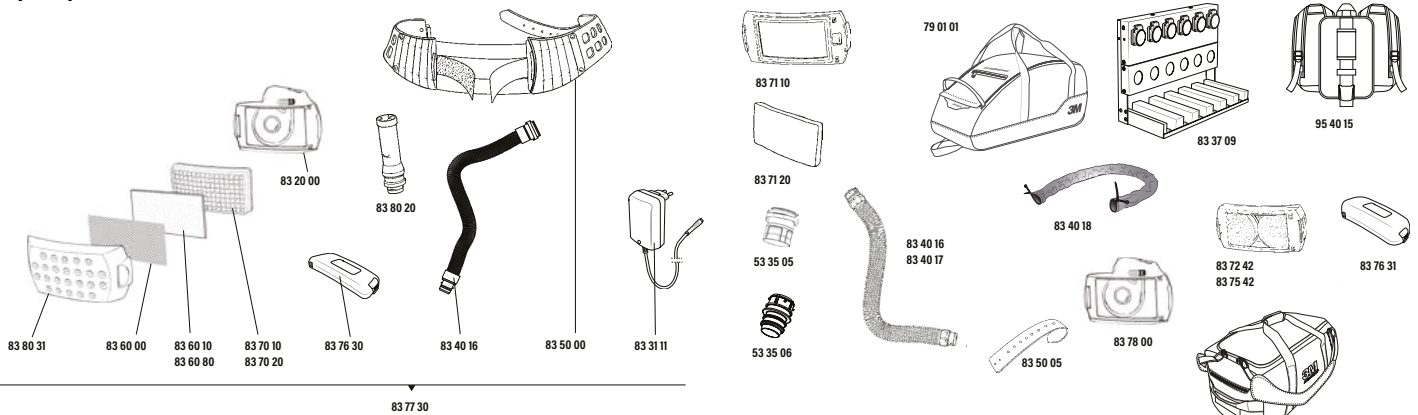

Part No.	Description	Part No.	Description	Part No.	Description
53 35 05	Adaptor Adflo Breathing Tube 9100 Air, FX Air, MP Air	83 50 00	Belt Adflo	83 75 42	Filter Gas A1 Adflo
53 35 06	Adaptor QRS Breathing Tube to 9000	83 50 05	Belt Extension Adflo	83 76 30 ¹⁾	Battery Standard Li-ion Adflo
79 01 01	Carry Bag Speedglas	83 60 00	Spark Arrestor Adflo	83 76 31 ¹⁾	Battery Heavy Duty Li-ion Adflo
79 01 05	Carry Bag Speedglas Heavy Duty	83 60 10	Pre-Filter Adflo Pk=5	83 76 35	Upgrade Kit Standard Li-ion Battery & Charger
83 20 00	PAPR Motor with Housing Adflo	83 60 80	Pre-Filter Adflo Pk=80	83 77 30	Respirator Standard Li-ion Adflo
83 31 11 ¹⁾	Charger Battery Li-ion Adflo	83 70 10	Filter Particle PSL Adflo	83 77 31	Respirator Heavy Duty Li-ion Adflo
83 37 09	Battery Multi-Station Adflo	83 70 20	Filter Particle PSL Adflo Pk=20	83 78 00	PAPR Motor with Housing Adflo High Altitude
83 40 16	Tube Breathing Self Adjusting QRS Adflo	83 71 10	Filter Odour Adflo	83 80 20	Airflow Indicator
83 40 17	Tube Breathing Heavy Duty Rubber QRS Adflo	83 71 20	Filter Odour Replacement Pad Adflo	83 80 31	Filter Cover Li-ion Adflo
83 40 18	Tube Breathing Cover Flame Resistant Adflo	83 72 42	Filter Nuis Level Organic Vapour/Acid Gas Adflo	95 40 15	Backpack Adflo

¹⁾ Lithium-ion (grey) batteries (83 76 30, 83 76 31) are only compatible with the Lithium-ion battery charger (83 31 11).

3M™ Adflo™ Powered Air Respirator System

An adaptable system.

With the right type of filter, the Adflo respirator helps reduce your exposure against both particles and gases—all in one system. And you can selectively replace either the particle or the OV/AG cartridge as needed: you don't need to change both filters at the same time.

- A. **Filter cover:** holds the different available Adflo filters.
- B. **Spark arrestor.**
- C. **Prefilter:** increases the service life of the particulate filter.
- D. **HE particulate filter:** high efficiency particulate filtration.
- E. **OV/AG cartridge:** filters certain organic vapours and acid gases; sold separately.
- F. **Odor filter:** removes unpleasant smells (not needed if a OV/AG cartridge is installed); sold separately.
- G. **Li-ion battery:** charges to 80% capacity in approx. 3 hours and to 100% capacity in approx. 6.5 hours, depending on its residual charge. Approximate operating time up to 12 hours with a new particle filter and new, fully charged battery.
- H. **Brushless motor:** with an average life three times longer than conventional motors.
- I. **Filter indicator:** indicates the status of the HE particulate filter.
- J. **Airflow:** Provides a constant nominal airflow rate of 205 lpm.
- K. **Breathing tube:** different options available.
- L. **Airflow:** for your maximum comfort, a diffuser evenly distributes filtered air throughout the entire breathing zone of the helmet. Plus, the intelligent turbo unit keeps the airflow rate at a constant, preset level.
- M. **Soft, flexible face seal (removed here for clarity):** creates a positive pressure environment within the helmet, keeping the surrounding pollutants at bay.





3M™ Speedglas™ Welding Helmet 9100 MP & 9100 MP-LITE

Helmet systems with powered air - 3M™ Speedglas™ Welding Helmet 9100 MP

- Multi Protection - 5 levels of protection: eye, face, head (safety helmet), respiratory and options hearing protection.

Helmet systems with supplied air - 3M™ Speedglas™ Welding Helmet 9100 MP-LITE

- Multi Protection - 5 levels of protection: eye, face, head (bump cap), respiratory and options hearing protection.

Part No.	Description
57 77 00	Welding helmet 9100MP without welding filter, with Adflo powered air respirator
59 77 00	Welding helmet 9100MP-Lite without welding filter, with Adflo powered air respirator
57 77 00 + 50 00 15	Welding helmet 9100MP with welding filter 9100X (54 x 107 mm) and Adflo powered respirator
57 77 00 + 50 00 15	Welding helmet 9100MP welding filter 9100XX (73 x 107 mm) and Adflo powered respirator
57 77 26	Welding helmet 9100MP welding filter 9100XXi (73 x 107 mm) and Adflo powered respirator
57 88 00	Welding helmet 9100MP without welding filter, with Versaflo supplied air regulator V-500E

Please note, supplied air regulators with heating or cooling (V-100/V-200) only as separate order (not as system)



3M™ Adflo™ Powered Air Respirator

Part No.	Description
83 77 30	With standard battery
83 77 31	With heavy duty battery



V-500E

Part No.	Description
V-500E	3M™ Versaflo™ Supplied Air Regulator

3M™ Speedglas™ Welding Helmet 9100 MP & 9100 MP-LITE - Spares & Accessories

To optimise the effective lifetime of your welding equipment and avoid the additional cost of replacement, regular maintenance is important. Replace all damaged parts immediately to ensure correct levels of protection.

Before use

- **Helmet and headband.** Inspect for cracks or any damaged or defective parts. Replace if needed.
- **Protection plates.** To provide the best possible vision they should be clean and without scratches.
- **Face seal.** If the face seal is damaged there is a great risk that contaminated air will get inside the helmet. Verify it's in place and free from splits and tears.
- **Welding filter.** Ensure low battery is not flashing and check that the sensors are clean and uncovered.
- **Breathing tube.** Confirm tube is not damaged or leaking any air. To extend the life of breathing tube, use a breathing tube cover or a heavy-duty rubber breathing tube.

After use

- **Clean the helmet.** Wipe with a moist tissue or cloth, both inside and outside the helmet. If you suspect that the inside of the breathing tube is dirty, it must be changed. DO NOT rinse, immerse in water or clean with solvents.
- **Face seal and sweatband.** Remove for additional cleaning as needed and replace if they are deeply pitted or whenever they become unhygienic.
- **Protection plates and visor plate.** Clean with a soft cloth and replace if any pits or scratches occur.
- **Breathing tube.** Replace if damaged, deformed or leaking any air.
- **Storage.** Store the helmet in a dry, clean area away from direct sunlight, high temperatures and solvents.

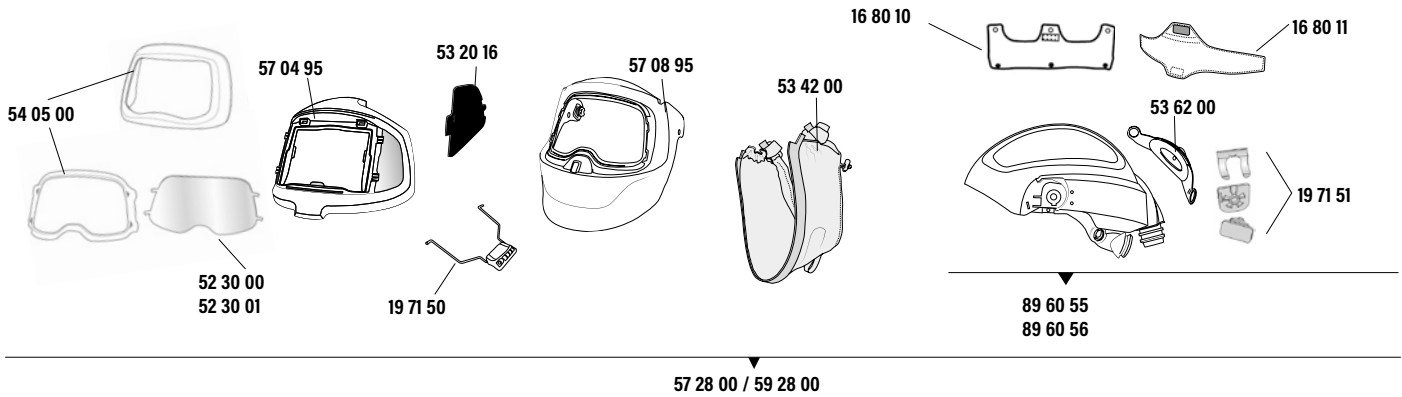

Part No.	Description	Part No.	Description	Part No.	Description
16 80 10	Sweatband, 9100 MP, pkg of 2	50 00 05	Speedglas welding filter 9100V	52 80 05	Inner cover plate for 9100V filter, pkg of 5. Plate marking 117x50
16 80 11	Sweatband, 9100 MP-Lite, pkg of 2	50 00 15	Speedglas welding filter 9100X	52 80 06	Inner cover plate, +1 shade for 9100V filters, pkg of 3
16 90 14	Safety helmet cover	50 00 25	Speedglas welding filter 9100XX	52 80 07	Inner cover plate, +2 shade for 9100V filters, pkg of 3
16 90 15	Shroud	50 00 26	Speedglas welding filter 9100XXi	52 80 15	Inner cover plate for 9100X filter, pkg of 5. Plate marking 117x61
17 10 20	Magnifying lens 1.0	52 30 00	Visor plate, standard, pkg of 5	52 80 16	Inner cover plate, +1 shade for 9100X filter, pkg of 3
17 10 21	Magnifying lens 1.5	52 30 01	Visor plate, anti-fog, pkg of 5	52 80 17	Inner cover plate, +2 shade for 9100X filter, pkg of 3
17 10 22	Magnifying lens 2.0	52 60 00	Outer protection plate standard, pkg of 10	52 80 25	Inner cover plate for 9100XX filter, pkg of 5. Plate marking 117x77
17 10 23	Magnifying lens 2.5	52 70 01	Outer protection plate extra scratch resistant, pkg of 10	52 80 26	Inner cover plate, +1 shade for 9100XX filter, pkg of 3
17 10 24	Magnifying lens 3.0	52 70 70	Outer protection plate heat resistant, pkg of 10	52 80 27	Inner cover plate, +2 shade for 9100XX filter, pkg of 3
19 71 50	Flip-up mechanism				
19 71 51	Pivot kit				
42 20 00	Battery, pkg of 2				

3M™ Speedglas™ Welding Helmet 9100 MP & 9100 MP-LITE - Spares & Accessories

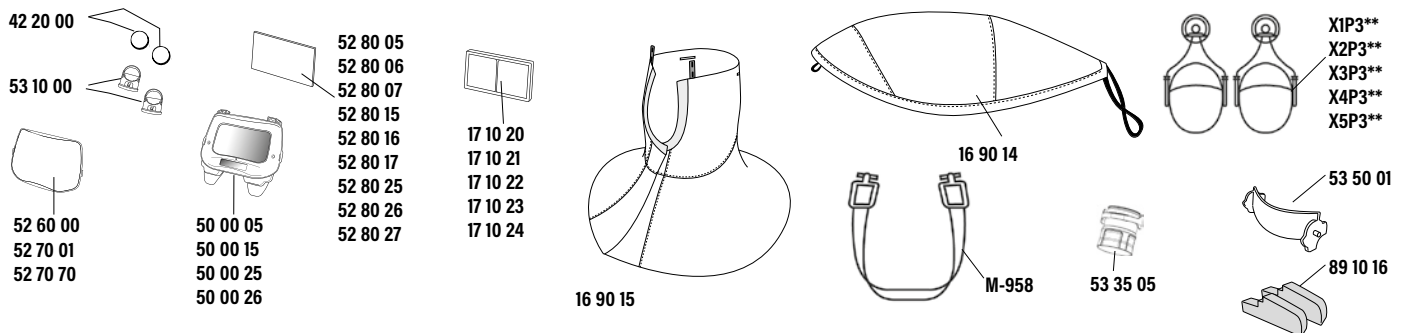

Part No.	Description	Part No.	Description	Part No.	Description
53 10 00	Battery holder, pkg of 2	89 10 16	Spare part Side Seal 9100 MP-Lite	X1P3	3MTM Peltor™ Ear Muffs X1 (26 dB)**
53 20 16	Side window cover plates	89 60 55	Safety helmet 9100 MP, incl head suspension and sweatband	X2P3	3MTM Peltor™ Ear Muffs X2 (30 dB)**
53 35 05	Welding helmet adapter when using old type of breathing tube (non-QRS)	89 60 56	Bump cap 9100 MP-Lite, incl head suspension and sweatband	X3P3	3MTM Peltor™ Ear Muffs X3 (32 dB)**
53 42 00	Face seal	M-958	Chin strap	X4P3	3MTM Peltor™ Ear Muffs X4 (33 dB)**
53 50 01	Helmet air flow deflector for 9100 MP-Lite	M-150	Head suspension for 9100 MP-Lite (Not shown)***	X5P3	3MTM Peltor™ Ear Muffs X5 (36 dB)**
53 62 00	Headband ratchet	M-350	Head suspension 9100 MP (not shown)	Z3AF/2	Helmet assembly parts for Peltor X-series ear muffs, left and right
54 05 00	Front cover kit				
57 04 95	Outer shield				
57 08 95	Inner shield				
57 28 00	Welding helmet 9100 MP, without welding filter				
59 28 00	Welding helmet 9100 MP-Lite, without welding filter				

** Please add assembly parts Z3AF/2 when ordering hearing protection for 9100MP welding helmet.

*** Must be purchased together with Sweatband, 9100 MP-Lite (16 80 11) in order to maintain regulatory approval.

3M™ Versaflo™ Helmets

3M™ Versaflo™ M-Series Helmets



The Versaflo™ M-Series modern, compact and well-balanced Headtops are highly versatile offering integrated protection from a range of respiratory, head, eye, face and hearing hazards.

The coated Polycarbonate visor design features a Deflector allowing users to direct the airflow inside the Headtop for increased control and comfort.

These Headtops combine excellent peripheral and downward vision with good optical clarity and with fully-adjustable suspension that includes textile straps for optimal fit and weight distribution.

Easy To Maintain - Spare parts and accessories are quick, easy and intuitive to replace.

Part No.	Description
M-207	3M™ Versaflo™ Faceshield with Flame Resistant Poly Faceseal, M-207 3M™ Versaflo™ M-207 Faceshield offers respiratory, bumpcap, eye and face EN166 Medium Impact protection. The helmet features a flame resistant polyester faceseal for applications with sparks and hot particles. M-207 helmet meets the performance requirements (TH3) for this type of product when used with specific 3M™ Versaflo™ Air Delivery Units. Bumpcap protection (EN812)



Part No.	Description
M-307	3M™ Versaflo™ Helmet with Flame Resistant Faceseal, M-307 The 3M™ Versaflo™ M-307 Helmet offers respiratory, eye EN166 Medium Impact and face protection as well as head protection EN397, essential for areas where hard hats are mandatory. M-307 features a flame resistant faceseal for applications with hot particles



Part No.	Description
M-407	3M™ Versaflo™ Helmet with Flame Resistant Shroud, M-407 Features a flame-retardant shroud for protection against hot particles. Fabric material: Polyaramid. Head protection approved according to EN 397 It meets the highest respiratory performance requirements (TH3) for this type of product when used with specific 3M™ Air Delivery Units, and it's easy to maintain with spare parts and accessories that are quick, easy and intuitive to replace



3M™ Versaflo™ Kits & 3M™ G500 Headgear

3M™ Versaflo™ Powered Air Turbo Heavy Industry Ready Kit **TR-300E+ HIK**

Part No.	Description
TR300HIK	3M™ Versaflo™ Powered Air Turbo Heavy Industry Ready Kit
	<p>The TR-300E+-HIK is a complete Powered Air Respirator System featuring a powered air turbo and filter designed for Particulate respiratory protection and including everything required to get started. This ready-to-use kit provides a simple way to purchase a complete powered air respirator system for use in rugged industrial environments.</p> <p>Two types of alarms - one audible and one visual - alert user to either a low battery or low flow, such as when a particle filter is fully loaded. LED lights on the battery indicate its charge status on and off the charger.</p>



TR-300+ HIK INCLUDES

- M-307 Helmet with Premium Visor and Faceseal
- TR-302E+ Powered Air Turbo
- TR-326 High Durability Belt
- TR-341E Battery Charger and UK Plug
- TR-3712E Filter
- TR-362 Spark Arrestor
- TR-3600 Pre-Filter
- TR-332 High Capacity Battery
- BT-40 Heavy Duty Breathing Tube
- BT-926 High Temperature Breathing Tube Cover
- TR-971 Airflow Indicator

3M™ Versaflo™ Powered Air Turbo Starter Kit

Part No.	Description
TR-315UK+	Powered air respirator
	<p>The Versaflo™ powered air system combines performance, protection and functionality with modern, stylish, lightweight design and unrivalled comfort. Powered Air Starter Kit TR-315UK+ contains TR-302E+ Turbo Unit, Particle Filter, Pre-Filter, Spark Arrestors, Standard Belt, High Capacity Battery, Battery Charger Kit and length adjusting Breathing Tube</p>



3M Headgear G500

Part No.	Description
G500V5FH	Headgear
	<p>G500 Headgear provides a versatile and comfortable solution for wearers who require both face and hearing protection. With special design features making it easy to combine the headgear with other 3M™ safety products such as face shields, passive earmuffs or communication headsets and integrated eyewear</p>



3M™ Respiratory

Disposable Respirators

3M™ Aura™ 9322+ & 9332+ Valved, Disposable Respirators

- Original 3-panel design allows for greater facial movement
- Maximum usage level: 9322+ up to 10 x WEL (FFP2), 9332+ up to 20 x WEL (FFP3)
- Low resistance filter technology helps you breathe more easily
- Sculpted upper panel conforms to the nose and contours of the face for an effective seal
- 3M™ Cool Flow™ Valve helps reduce heat build-up in hot and humid conditions
- Embossed top panel helps reduce eyewear fogging
- Chin tab designed for ease of adjustment
- Easy to store
- Colour-coded headbands for easy identification: blue for FFP2 and red for FFP3



Part No.	Description	Qty
9322+	FFP2 Respirator	Boxes of 10

Part No.	Description	Qty
9332+	FFP3 Respirator	Boxes of 10

3M™ 8825+ & 8835+ Valved, Disposable Respirators

- Tested and CE Approved to EN 149:2001+ A1:2009
- Maximum usage level: 8825+ up to 10 x WEL (FFP2), 8835+ up to 20 x WEL (FFP3)
- Soft inner face-seal ring improves face seal, wearer comfort and allows for hygienic cleaning if used for longer than one shift (Rated 'R' = Reusable)
- Robust shell and cup design provides multi-shift capability and a securer feel
- 4 Point adjustable braided headbands help achieve a more secure feel
- 3M™ Advanced Electret Filter Material offers effective filtration
- 3M™ Cool Flow™ exhalation valve for comfort in hot humid environments
- Coloured head straps for easy identification: blue for FFP2 and red for FFP3



Part No.	Description	Qty
8825+	FFP2 Respirator	Boxes of 10

Part No.	Description	Qty
8835+	FFP3 Respirator	Boxes of 10

3M™ 8000 Series Cup-Shaped, Disposable Respirators

- Traditional cup-shaped disposable respirator
- 3M™ Cool Flow™ Valve: The Cool Flow valve reduces heat build-up inside the respirator – even in hot and humid conditions
- Colour-coded headbands offer easy protection level identification – colour coded blue: FFP2 (APF = 10), red: FFP3 (APF = 20)
- 3M™ Cool Flow™ Valve reduces heat and moisture build-up to offer worker comfortable protection – even in hot and humid conditions
- Maximum usage level: 8822 up to 10 x WEL (FFP2), 8833 up to 20 x WEL (FFP3, also rated R = Reusable)



Part No.	Description	Qty
8822	FFP2 Respirator	Boxes of 10

Part No.	Description	Qty
8833	FFP3 Respirator	Boxes of 10

3M™ Respiratory

3M™ Maintenance Free Reusable Half Mask 4000+ Series

3M™ Maintenance Free Half Mask 4000+ Series is a range of simple and ready-to-use respirators with integrated filters. A newly enhanced valve assembly helps to reduce exhalation breathing resistance, and the close-fitting, non-silicone, textured face seal is soft and non-allergenic. Includes a resealable bag for hygienic storage and transportation.

- Effective and comfortable protection against a range of vapour and particulate hazards
- Lightweight, well-balanced design
- Integrated cartridge and filters mean it's ready to use and maintenance free
- Soft, close-fitting face seal made with textured, non-allergenic material
- Adjustable head cradle and easy to fasten neck straps
- Centrally-positioned exhalation valve helps reduce heat and moisture build-up in hot and humid conditions



Protection Factor			Qty
4251+	Organic vapour + particulate respirator	FFA1P2 R D	10
4255+	Organic vapour + particulate respirator	FFA2P3 R D	10
4277+	Organic vapour / inorganic + acid gas / particulate respirator	FFABE1P3 R D	10
4279+	Organic vapour / inorganic + acid gas / ammonia / particulate respirator	FFABEKIP3 R D	10

3M™ Secure Click™ Half Mask Reusable Respirator, Speaking Diaphragm, HF-800SD series

Designed with smart and intuitive features, the 3M™ Secure Click™ Half Facepiece Reusable Respirator HF-800 Series helps protect workers from particulates and a wide variety of gases and vapours when used with approved 3M™ Secure Click filters.

Available in 3 sizes, HF-801SD - Small, HF-802SD - Medium, HF-803SD - Large



Gas and Vapour Filters



Gas, Vapour and Particulate Combination Filters



Particulate Filters



Particulate Filters with Nuisance Level Organic Vapour and Acid Gas Protection and Ozone up to 10 x WEL



Particulate Filters
(for use in combination with gas and vapour filters)



Filters Retainer
(for use in combination with gas and vapour filters)

3M™ Hearing Protection

3M™ Earplugs 1100 Series

The 3M™ 1100 Earplugs are disposable foam earplugs designed for insertion into the ear canal to help reduce exposure to hazardous levels of noise up to 35 dB, tested to EN 352-2:2020.

Part No.	Description	Qty
1100	3M™ Earplugs 1100, 37dB, Uncorded	200 pairs/box
1100R	3M™ Earplugs 1100, Top-up Bag, Uncorded	2000 pairs/box



3M™ E-A-R™ Classic™ Earplugs

The 3M™ E-A-R™ Classic™ Earplugs are disposable and designed for insertion into the ear canal to help reduce exposure to hazardous levels of noise and loud sound. These products are available in a corded and uncorded version.

Part No.	Description	Qty
PP-01-002	3M™ Classic™ Earplugs pillowpack	250 pairs
CC-01-001	3M™ Classic™ Earplugs corded	100 pairs



3M™ E-A-Rsoft™ Yellow Neons™ Earplugs

3M™ E-A-Rsoft™ Yellow Neons™ Earplugs are our highly visible neon-yellow earplugs made of smooth, comfortable foam. They can reduce noise levels by 36 dB making them ideal for a variety of loud noise applications.

Part No.	Description	Qty
ES-01-001	3M™ E-A-Rsoft™ Yellow Neons™ Earplugs	250 pairs
ES-01-005	3M™ E-A-Rsoft™ Yellow Neons™ Earplugs corded	200 pairs



3M™ Hearing Protection

3M™ PELTOR™ X Series

X Series earmuffs combine 3M™ Peltors™ legendary hearing protection knowledge with our most advanced technologies, creating our most comfortable, curable earmuff. A broad range of protection in colour coded SNRs they make finding the correct protection level easier.

- Offers protection from 27 dB to markets highest 37 dB
- Wide flat headband is electrically insulated making the earmuffs electrically resistant or 'dielectric'
- Colour-coding makes it easy to identify the level of protection being worn
- Slim cups offer improved compatibility with other safety equipment
- Wide soft ear cushions help workers stay comfortable
- Twin headband design provides heat dispersion and internal stainless steel design offers consistent pressure and comfortable fit over an 8 hour period
- Designed to optimise weight distribution and balance for outstanding comfort
- ABS plastic cups are rigid, high strength and impact resistant
- Thermoplastic polyurethane (TPU) soft outer cup coating protects from abrasion and bumps
- Available in Headband, Helmet Mounted and Neckband versions



Part No. (Headband)	Part No. (Helmet Mounted)	Part No. (Neckband Versions)	Description
X1A	X1P3	X1B	3M™ Peltor™ Ear Defenders X1
X2A	X2P3	X2B	3M™ Peltor™ Ear Defenders X2
X3A	X3P3	X3B	3M™ Peltor™ Ear Defenders X3
X4A	X4P3	X4B	3M™ Peltor™ Ear Defenders X4
X5A	X5P3	X5B	3M™ Peltor™ Ear Defenders X5



3M™ Eye Protection

Safety Glasses

3M™ SecureFit™ 100 Safety Glasses

- Slim frame
- 3M™ Pressure Diffusion Temple Technology
- Lens shades in clear and grey
- All lens options available with anti-scratch/anti-fog coatings
- Typical weight: 20g

Part No.	Description	Qty
7100244046	SF101-BLK, Anti-Scratch, Clear Lens, 5/pk	10
7100244060	SF101-BLK, Anti-Fog, Clear Lens, 5/pk	10
7100244061	SF107-BLU, I/O, Anti-Scratch, Grey Lens	10



3M™ SecureFit™ SF200 Series Protective Eyewear

- Optical class 1 lens suitable for prolonged use
- Design provides excellent coverage and a good field of vision based on the rimless, single lens design
- Offers protection against ultraviolet (UV) radiation
- Typical weight: 18g

Part No.	Description	Qty
710011990	SF201-EU, Anti-Fog, Clear Lens	10
7100112180	SF201-EU, Anti-Scratch, Clear Lens	10
7100112008	SF203-EU, Anti-Fog, Amber Lens	10



3M™ SecureFit™ 500 Safety Glasses

- Helps provide durable scratch resistance in tough environments
- The 3M™ Scotchgard™ coating is tested to EN 168 K&N for Anti-Fog/Scratch performance
- Optional foam gasket
- Typical weight: 22g or 27g with foam gasket

Part No.	Description	Qty
7100244045	SF501-BLK, Anti-Fog, Clear Lens	10
7100243979	SF501-BLK, Anti-Scratch, Clear Lens	10
7100243142	SF501-BLK, Scotchgard Anti-Fog/Scratch, Clear Lens	10
7100243964	SF501BLK-FM, Scotchgard Anti-Fog/Scratch, Clear Lens + Foam	10
7100243977	SF517-GRN, I/R 1.7, Anti-Scratch Plus, Grey Lens	10
7100243978	SF550-GRN, IR 5.0, Anti-Scratch Plus, Grey Lens	10
7100243943	SF500-FOAM, Foam Gasket for SF500	10



3M™ Eye Protection

Safety Goggles

3M™ GoggleGear™ Safety Goggles 2890 Series

- Large profile 3M™ GoggleGear™ Safety Goggles range, with enough space to fit over most prescription glasses
- Polycarbonate lens options available for impact resistance and acetate lens options available for improved chemical resistance
- Indirect ventilation versions available to protect against liquid droplets and large dust particles and sealed ventilation versions available to protect against small dust particles and gas protection
- Cylindrical curved lens design for optimal horizontal field of vision
- 3M™ Scotchgard™ Anti-Fog Coating provides superior anti-fog and anti-scratch properties (available on selected models)
- Wide flexible nose area to fit well with half-mask respirators
- GG2895S with IR 5 lens filter popular for gas welding and metal cutting

Part No.	Description	Lens
2890	Goggle PC Clear AS/AF	Clear PC
2890A	Goggle Acetate AF	Clear Acetate
2890S	Goggle Sealed PC AS/AF	Clear PC
2890SA	Goggle Sealed Acetate AF	Clear Acetate
2895S	Welding Goggle PC Shade 5 AS/AF	Welding PC
2891-SGAF	SGAF Goggle PC Clear SGAF	Clear PC
2891S-SGAF	SGAF Goggle Sealed PC Clear SGAF	Clear PC



3M™ GoggleGear™ Safety Goggles 6000 Series

- Large profile 3M™ GoggleGear™ Safety Goggles range, with enough space to fit over most prescription glasses and indirect airflow to help against fogging
- Premium spherical curved lens design for optimal horizontal and vertical field of vision
- 3M™ Scotchgard™ Anti-Fog Coating provides superior anti-fog and anti-scratch properties
- Pivoting ratchet for convenient personal adjustment
- Easy-to-adjust elastic textile headband for stability and comfort
- Wide flexible nose area to fit well with half-mask respirators
- GG6001NSGAF-BLU with neoprene headband can be sterilised up to 40x by autoclaving at 121°C
- Flip-up version available with a grey IR 5 lens filter popular for gas welding and metal cutting

Part No.	Description	Lens Colour	Frame Colour
GG6001SGAF-BLK	3M™ GoggleGear™ 6000 Safety Goggles, Black Shroud, Scotchgard™ AF/AS Coating (K&N)	Clear	Black
GG6002SGAF-BLK	3M™ GoggleGear™ 6000 Safety Goggles, Black Shroud, Scotchgard™ AF/AS Coating (K&N)	Grey	Black
GG6001SGAF-GRN	3M™ GoggleGear™ 6000 Safety Goggles, Lime Green Shroud, Scotchgard™ AF/AS Coating (K&N)	Clear	Green
GG6001SGAF-RED	3M™ GoggleGear™ 6000 Safety Goggles, Red Shroud, Scotchgard™ AF/AS Coating (K&N)	Clear	Red
GG6001NSGAF-BLU	3M™ GoggleGear™ 6000 Safety Goggles, Blue Shroud, Neoprene Strap, Scotchgard™ AF/AS Coating (K&N)	Clear	Blue
GG6001SGAF-IR5	Clear Lens, with Flip-Up Grey IR5 Cover Lens	Clear	Black



3M™ Fibre Discs & Flap Discs

3M™ Electric Angle Grinder, 115mm, 240v

3M™ Electric Angle Grinder is designed for use with 3M abrasives and accessories to create a comprehensive system to achieve a more professional finish in less processing time. Our electric angle grinder has a powerful 1900 watt motor and an ergonomic handle to reduce vibration and enhance operator comfort.



Part No.	Description	Qty
14144	High powered grinding. Designed for operator comfort. Maximise productivity to minimise processing	1 each/case

3M™ Cubitron™ 3 Fibre Disc 1182C

The 3M™ Cubitron™ 3 Fibre Disc 1182C features re-engineered 3M Precision Shaped Grain — taking the legendary speed and life of 3M™ Cubitron™ Performance Abrasives to a whole new level. These product benefits include allowing for increased productivity and lower overall grinding costs vs. other fibre discs and depressed centre grinding wheels when grinding mild or carbon steels. Delivering up to 60% more total material removed compared to the 3M™ Cubitron™ II Fibre Disc 982C, 36+, this long-lasting fibre disc has a fast cut rate with high stock removal across a wide range of application pressures. Additionally, this disc is designed to help reduce exposure to hand-arm vibration, increase throughput, and complete more parts-per-disc when tackling medium to high-pressure grinding applications.

Part No.	Diameter (mm)	Centre Hole (mm)	Grit	Max RPM	Accessory	Box Qty
7100309794	180	22	36+	8500	64862	25/bag, 100 ea/case
7100308531	125	22	36+	12000	64861	25/bag, 100 ea/case
7100308530	115	22	36+	13300	64860	25/bag, 100 ea/case



3M | Cubitron™ 3

Up to 26% Faster initial cut rate*

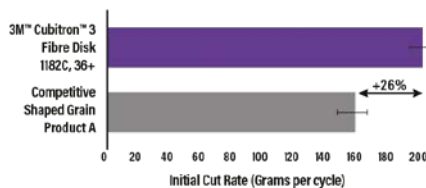

Up to 36% Faster sustained cut rate*

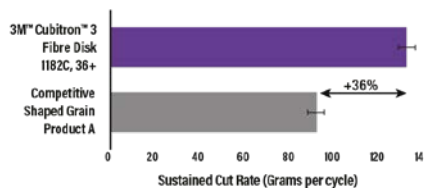

Up to 34% More total material removed

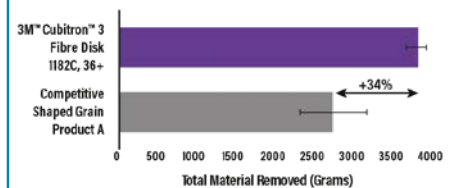

3M™ Cubitron™ II Fibre Disc 982CX Pro

The new 3M™ Cubitron™ II Fibre Disc 982CX Pro features reinvented precision-shaped grain and redesigned construction for faster cutting, longer life and improved performance. Ideal for medium and high-pressure applications such as weld removal, bevelling and other aggressive grinding applications. Best performance from machines greater than 1200Watts.

Part No.	Diameter (mm)	Centre Hole (mm)	Grit	Max RPM	Accessory	Box Qty
83323	115	22	36+	13300	64860	25
83322	125	22	36+	12000	64861	25
83321	180	22	36+	8600	64862	25



3M | Cubitron™ 2

Also available in 125mm, 180mm & 120+ grade.

2X Faster cut rate than high-quality grinding wheels^(a)

75% Less noise energy than high-quality 2 & 3 discs^(b)

83% Less vibration exposure than high-quality grinding wheels^(c)

(a) Performance testing in a typical weld preparation process; fibre disc 982CX Pro 36+ average compared to the average result of the high-quality bonded wheels tested, according to testing by Fraunhofer Institute.

(b) Noise level operator exposure testing in a typical weld preparation process; fibre disc 982CX Pro 36+ average compared to the average result of the high-quality bonded wheels tested, according to Fraunhofer Institute.

(c) Hand-arm vibration operator exposure testing in a typical weld preparation process; fibre disc 982CX Pro 36+ average compared to the average result of the high-quality bonded wheels tested, according to testing by Fraunhofer Institute.

3M™ High Performance Ribbed Back-Up Pad

Use 3M™ Ribbed Back Up Pad with 3M™ Cubitron 2 & 3 discs for improved disc cut and lifespan. Our pad features a unique rib pattern and is resistant to temperatures over 212°F (100°C). It helps to improve efficiency and reduce costs.

- Unique rib pattern
- Resistant to temperatures over 100°C (212°F)
- Use to extend the cut rate and lifespan of 3M™ Cubitron 2 & 3 discs.

Part No.	Description	Diameter (mm)
7000032409	3M™ High Performance Ribbed Back-Up Pad, Red	115
7000032410	3M™ High Performance Ribbed Back-Up Pad, Red	125
7000032411	3M™ High Performance Ribbed Back-Up Pad, Red	180

3M™ Cut-Off Wheels & Grinding Wheels

3M™ Cubitron™ 3 Cut-Off Wheel

The 3M™ Cubitron™ 3 Cut-Off Wheel creates perpendicular cuts using the outer edge of the wheel, making it ideal for cutting through metal, including autobody or marine sheet metal, stainless steel tubing, exhaust pipes, clamps, rusted fasteners and more. Additionally, the 3M™ Cubitron™ 3 Cut-Off Wheel is powered by 3M Re-Engineered Precision Shaped Grain using proprietary breakthroughs in molecular bonding technology designed with sharp, angular structures that continuously fracture to form sharp points. These clean, sharp points help create an abrasive that slices faster, runs cooler, and lasts much longer than conventional abrasives.

Part No.	Diameter (mm)	Thickness (mm)	Centre Hole (mm)	Type	Max RPM	Box Qty
86616	115	1.0	22.23	41	13300	25
89573	115	1.6	22.23	41	13300	25
88383	115	2.5	22.23	42	13300	25
86457	125	1.3	22.23	41	12250	25
86647	125	1.0	22.23	41	12250	25
88768	180	2.0	22.23	41	8500	25
88732	230	2.0	22.23	41	6650	25



3M | Cubitron™ 3

3M™ Cubitron™ 3 Depressed Centre Grinding Wheel

The 3M™ Cubitron™ 3 Depressed Centre Grinding Wheel is an exceptionally fast-cutting and long-lasting rigid-bonded wheel for heavy weld removal and other heavy-duty grinding applications. Utilising a depressed centre to enable grinding at any angle, this wheel works well on almost all materials while being specially formulated for use on stainless steel, mild steel, and aerospace alloys. Additionally, the 3M™ Cubitron™ 3 Depressed Centre Grinding Wheel is powered by 3M Re-Engineered Precision Shaped Grain using proprietary breakthroughs in molecular bonding technology designed with sharp, angular structures that continuously fracture to form sharp points. These clean, sharp points help create an abrasive that slices faster, runs cooler, and lasts much longer than conventional abrasives.

Part No.	Diameter (mm)	Thickness (mm)	Centre Hole (mm)	Type	Max RPM	Box Qty
99306	115	7	22.23	27	13300	10
98647	125	7	22.23	27	12250	10
98418	180	7	22.23	27	8500	10
98291	230	7	22.23	27	6500	10



3M | Cubitron™ 3

3M™ Silver Cut-Off Wheels

3M™ Silver Cut-Off Wheel is designed to deliver an unbeatable combination of performance and value. It cuts quickly through metal pipes, tubes and flat sheets. The long-lasting wheel uses our Precision Shaped Grain to deliver a fast, consistent cut. Use when you are doing multiple jobs and a large variation of work.

Part No.	Diameter (mm)	Thickness (mm)	Centre Hole (mm)	Type	Max RPM	Box Qty
51785	115	1.0	22.23	41	13300	25
51787	115	1.6	22.23	41	13300	25
51800	115	2.5	22.23	42	13300	25
51790	125	1.0	22.23	41	12250	25
51797	180	2.0	22.23	41	8500	25
51804	230	2.0	22.23	41	6650	25



3M™ Silver Depressed Centre Grinding Wheels

3M™ Silver Depressed Centre Grinding Wheel is our type 27 wheel, designed to deliver an unbeatable combination of performance and value that delivers a fast and consistent cut during grinding and heavy stock removal on stainless steel, mild steel, aerospace alloys and more. Use when you are doing multiple jobs and a large variation of work.

Part No.	Diameter (mm)	Thickness (mm)	Centre Hole (mm)	Type	Max RPM	Box Qty
51747	115	7	22.2	27	13300	10
51748	125	7	22.2	27	12250	10
51750	178	7	22.2	27	8500	10
51751	230	7	22.2	27	6500	10



3M™ Flap Disc 769F

3M Flap Disc 769F is designed medium to high unit-pressure applications. The primary substrates for this product are carbon steel, stainless steel and other nickel/chromium-based alloys.

Part No.	Diameter (mm)	Centre Hole (mm)	Grade	Max RPM	Type	Box Qty
51991	115	22	40+	13300	Conical	10
51993	115	22	60+	13300	Conical	10
51995	115	22	80+	13300	Conical	10



Also available in 125mm & 180mm and 120+ grade.

Surface Conditioning Discs and Bristle Discs

Scotch-Brite™ Shaft Mounted Bristle Disc

Scotch-Brite™ Shaft Mounted Bristle Disc gives a uniform finish efficiently cleaning and preparing even highly contoured surfaces. Our bristle discs are ideal for use on details, grooves, patterns and intricate areas. Our bristle products work harder and faster than traditional abrasives without sacrificing the finish quality. They offer savings on processing times, for a wide range of applications. Particularly suited to weld cleaning and oxidization removal applications.



Part No.	Diameter (mm)	Max RPM	Grade	Box Qty
62968	76	10000	P80	6

Also available in other grades P120 and P220.



Scotch-Brite™ Precision Surface Conditioning Disc, PN-DH

Now with 3M™ precision shaped grain technology - setting a new standard of performance. Designed for ease of use and consistent surface finishing results, conformable and conformable non-woven material disc conditions surfaces without gouging, undercutting or damaging the base material. Suitable for aluminium and soft metals, carbon steel, stainless steel, composite, plastics and more.



Part No.	Diameter (mm)	Centre hole (mm)	Grade
7100274225	115	22.23	Extra Coarse

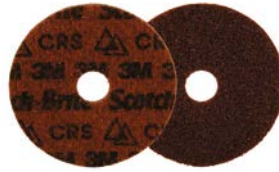

Part No.	Diameter (mm)	Centre hole (mm)	Grade
7100274279	115	22.23	Coarse



Part No.	Diameter (mm)	Centre hole (mm)	Grade
7100275844	115	22.23	Medium



Part No.	Diameter (mm)	Centre hole (mm)	Grade
7100275836	115	22.23	Fine

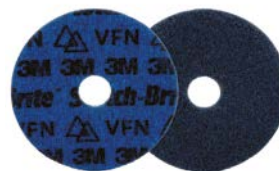

Part No.	Diameter (mm)	Centre hole (mm)	Grade
7100275845	115	22.23	Very Fine

3M™ Flat Back-up Pad

Specially designed, hard, ribbed backup pad. Hard rubber construction works with fibre disc backing for consistent support. Reduces vibration for greater operator comfort.

Part No.	Diameter (mm)	Thread	Box Qty
64857	115	M14	10





3M™ Helmets and Discs

Welding Helmets

Welding Wire and Electrodes

Abrasives / Grinding / Sanding / Cutting / Discs

Welding Torches

Welding Machines

MIG Welders for Sale

TIG Welders for Sale

Welding Gauntlets and Gloves

PPE for Welding

Gas Equipment

HSE Products

Welder Hire and Service Centre



Everything for the Welder

Wolverhampton: 01902 712525 | Shrewsbury: 01743 468902 | Stoke: 01782 848547

www.wirs.co.uk | sales@wirs.co.uk

